

	DATE	BY	REVISION
A	02/07/11	LSE	DRAWN
B	03/24/11	LSE	6 MESH X .028" WAS .035"

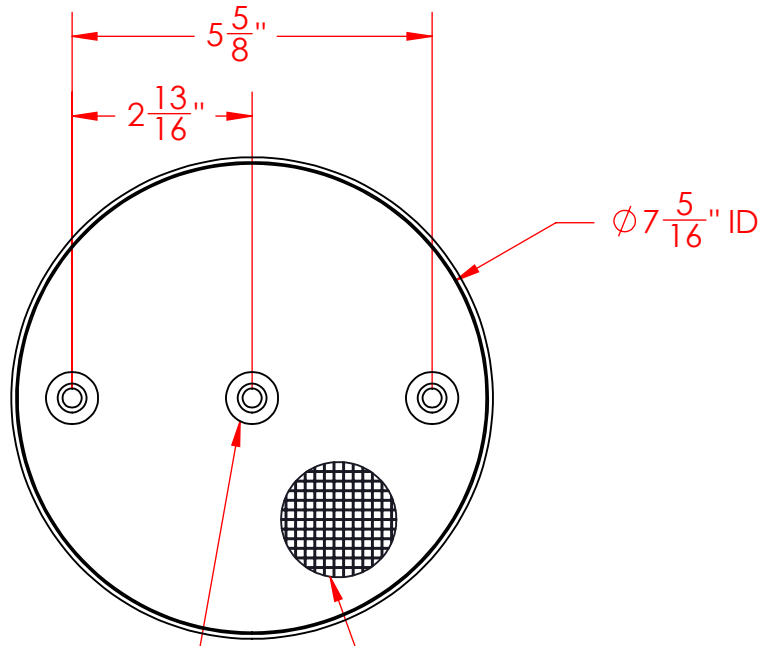

SS GROMMET  
 $\varnothing$  3/8" ID  
 SWAGE TO BE INSIDE

6 MESH X .028" WOVEN  
 (.138" OPENINGS)

$\varnothing$  7  $\frac{5}{16}$ " ID

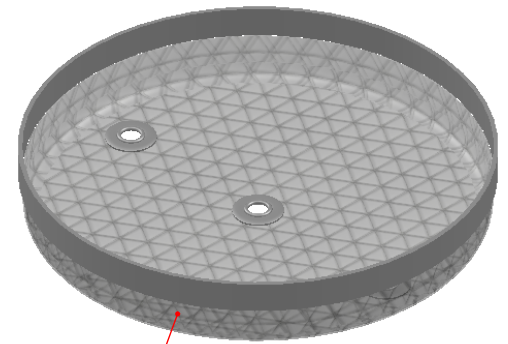

1 PIECE FORMED BODY

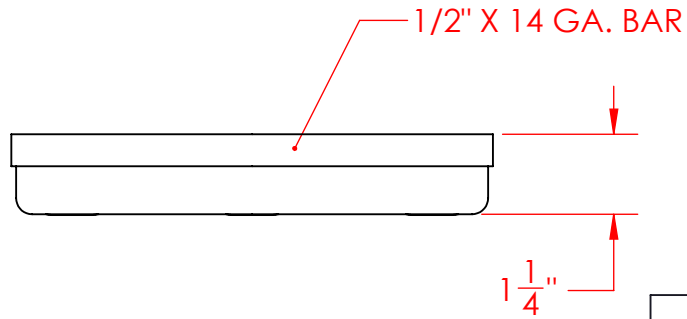

1/2" X 14 GA. BAR

1  $\frac{1}{4}$ "

ESTIMATED Wt.: 0.481 lbs.



Three M Tool  
 1038 Elm Street  
 York, PA 17403  
 Phone: 717-854-6379  
 Fax: 717-845-5232  
 www.ThreeMTool.com

TOLERANCES  
 UNLESS NOTED OTHERWISE  
 ANGLES:  $\pm$  2 DEGREES  
 FRACTIONS  $\pm$  1/16  
 .X  $\pm$  .125  
 .XX  $\pm$  .063  
 .XXX  $\pm$  .032

MATERIAL: 304 SS  
 FINISH: Natural

PART DESCRIPTION  
**Carburetor Screens**

Intensity Racing Products

THIRD ANGLE PROJECTION

REVISION SHEET SIZE

PART NUMBER

SCALE: NONE

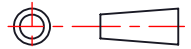

**B**

**A**

**IRP-07RND01**

SHEET 1 OF 1