

	DATE	BY	REVISION
A	11/15/2019	KPV	INITIAL DESIGN
	5/13/2020	KPV	AS BUILT: Supports moved for manufacturability

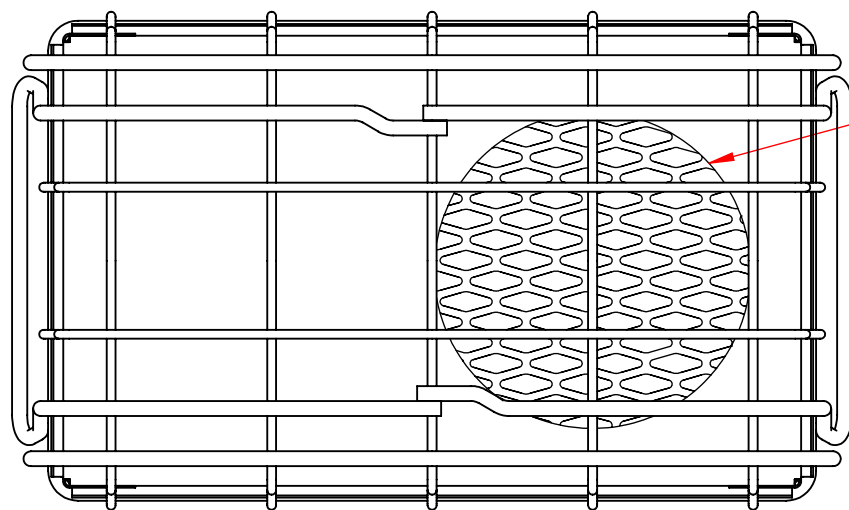
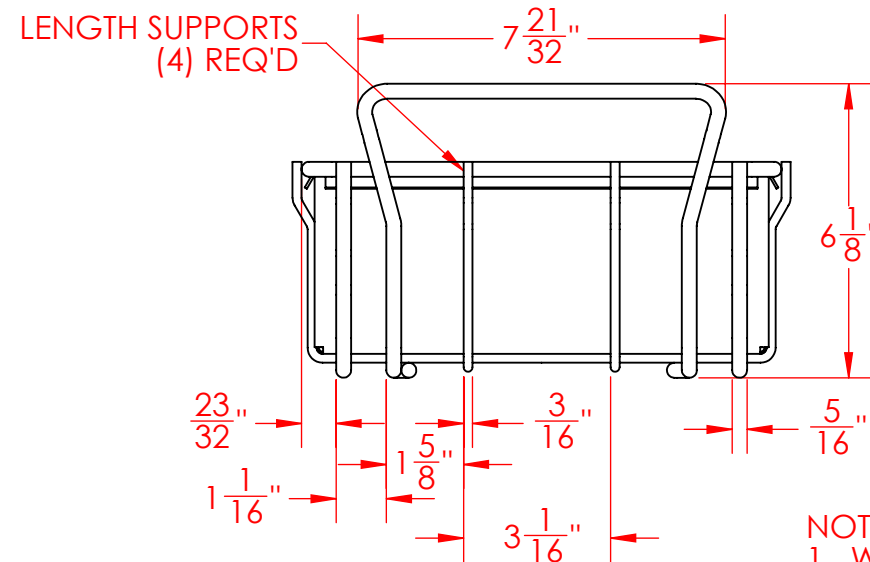
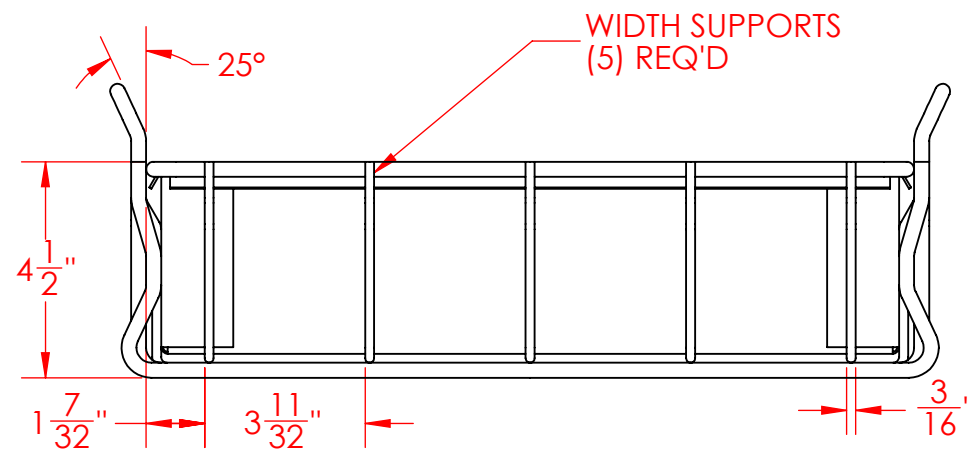
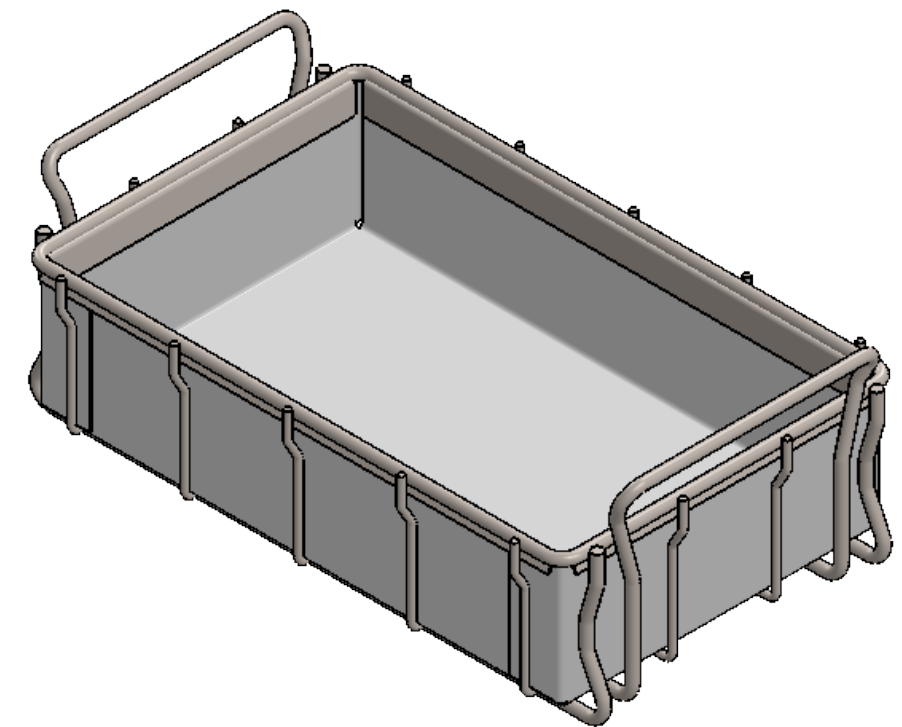
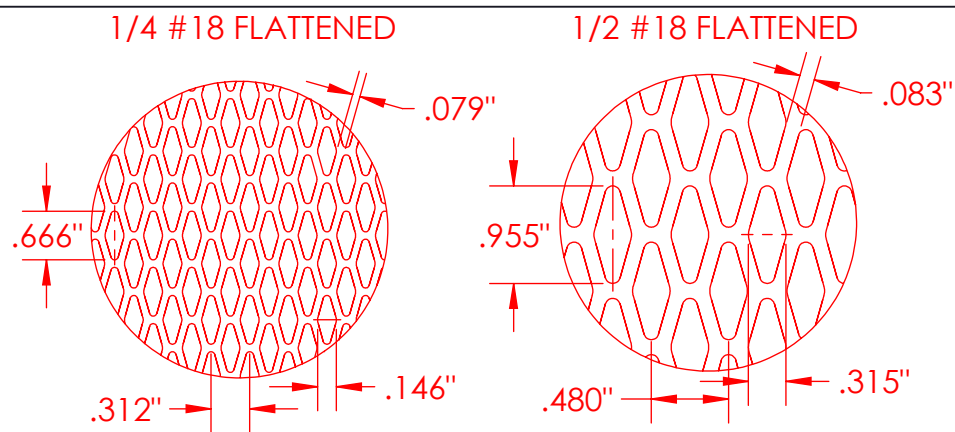
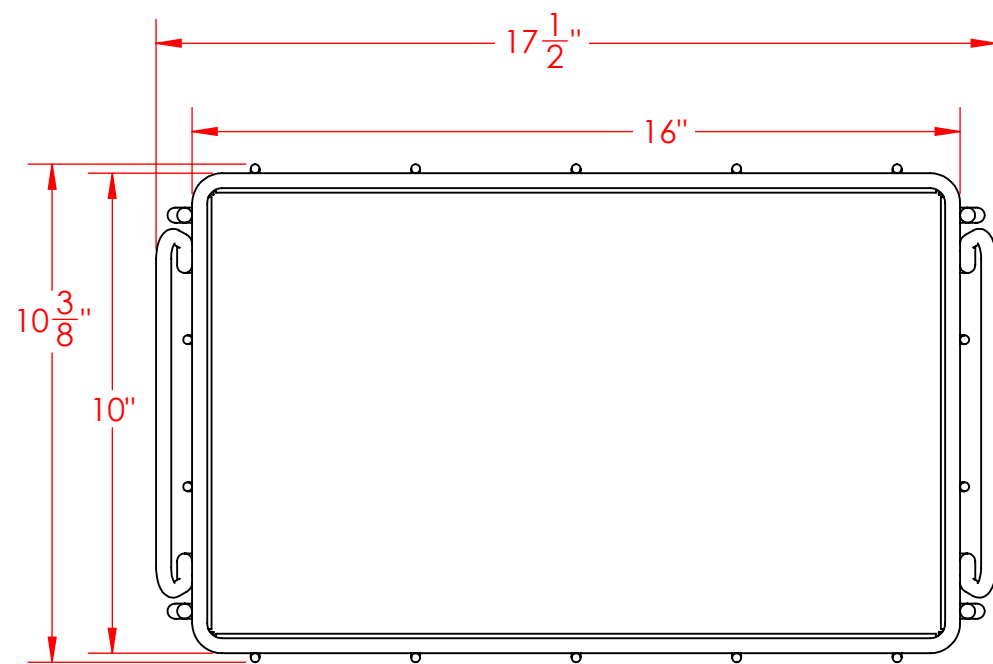

NOTE:
1. WIRE BRUSH TO REMOVE ALL T.I.G WELD DISCOLORATION

PART NUMBER	LINING	FINISH
TOTE-161005-E12-CS	1/2" x #18 Flattened Expanded Metal	Natural Steel
TOTE-161005-E12-PS	1/2" x #18 Flattened Expanded Metal	Zinc Plated
TOTE-161005-E12-SS	1/2" x #18 Flattened Expanded Metal	Natural SS
TOTE-161005-E14-CS	1/4" x #18 Flattened Expanded Metal	Natural Steel
TOTE-161005-E14-PS	1/4" x #18 Flattened Expanded Metal	Zinc Plated
TOTE-161005-E14-SS	1/4" x #18 Flattened Expanded Metal	Natural SS

ESTIMATED Wt. 7.0 (lbs.)

MATERIAL: See Chart

FINISH: See Chart

TOLERANCES UNLESS NOTED OTHERWISE
 ANGLES: ± 2 DEGREES
 FRACTIONS ± 1/16
 .X ± .125
 .XX ± .063
 .XXX ± .032

THIRD ANGLE PROJECTION

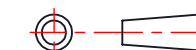

SCALE: 1:4

SHEET 1 OF 4

THE INFORMATION CONTAINED ON THIS DOCUMENT IS THE INTELLECTUAL PROPERTY OF THREE M TOOL AND MAY NOT BE COPIED OR DISCLOSED WITHOUT PRIOR WRITTEN PERMISSION FROM THREE M TOOL.

SHEET SIZE

B



Three M Tool

1038 Elm Street
 York, PA 17403
 Phone: 717-854-6379
 Fax: 717-845-5232
 www.ThreeMTool.com

PART DESCRIPTION

Stacking Tote Basket, 16" x 10" x 4-1/2"

Three M Tool

PART NUMBER

TOTE-161005-EXX-XX - REV A