

	DATE	BY	REVISION
A	9/15/15	Gilgore	INITIAL DESIGN
A	3/7/18	Gilgore	(Fab revision)- Eliminate (2) center vertical supports

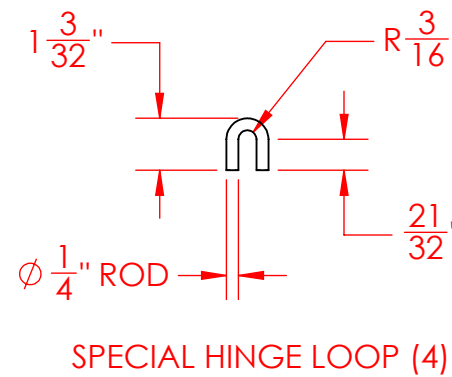
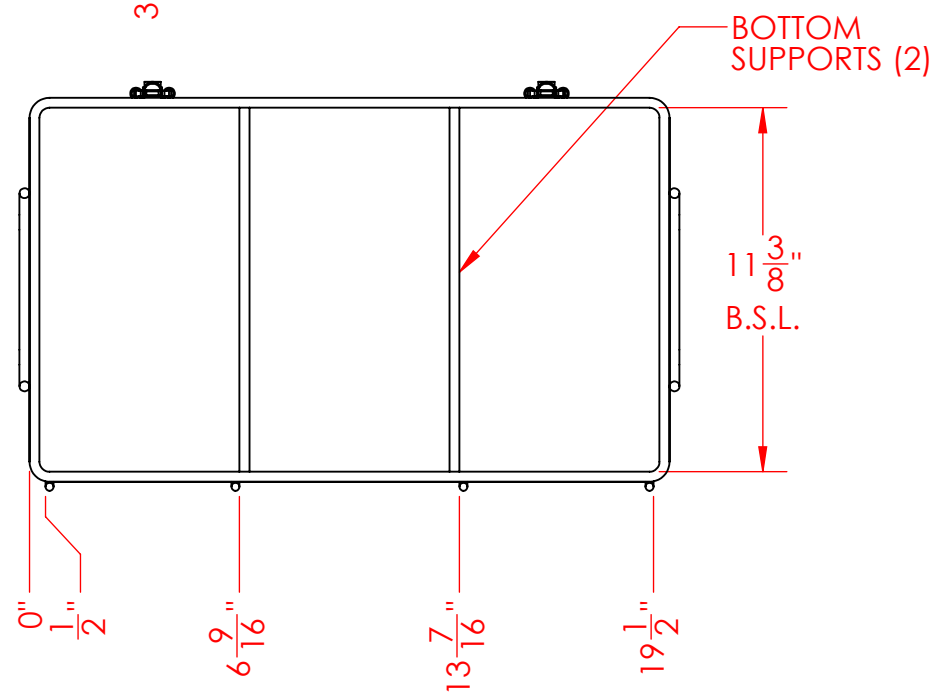
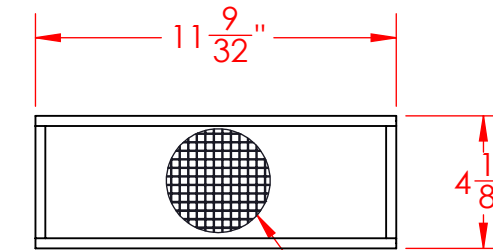
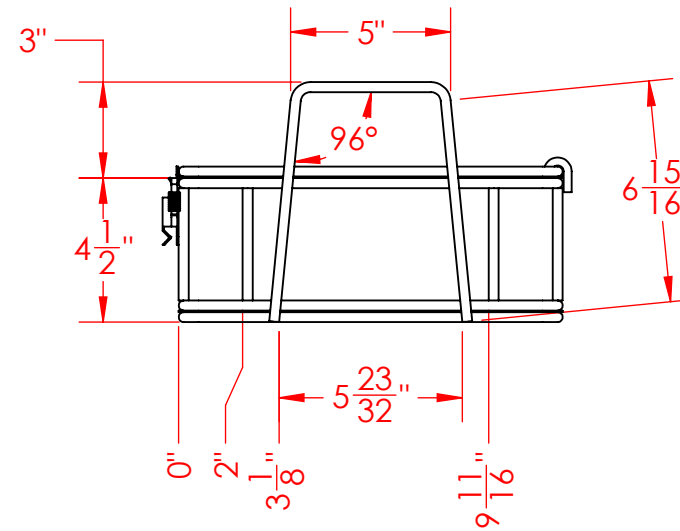
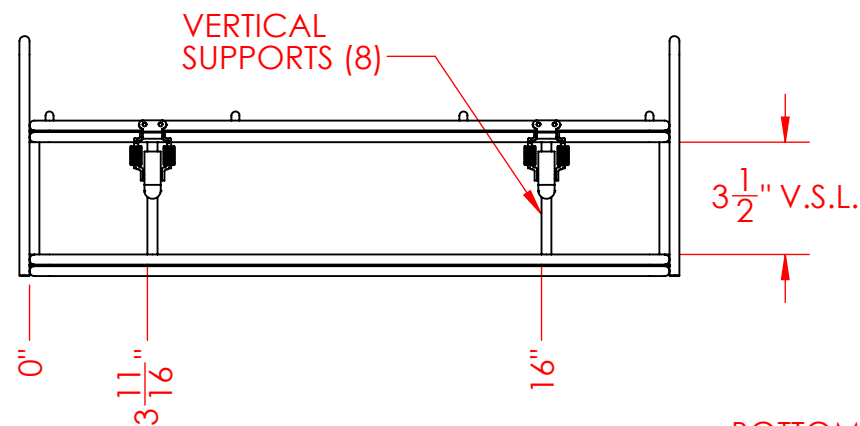
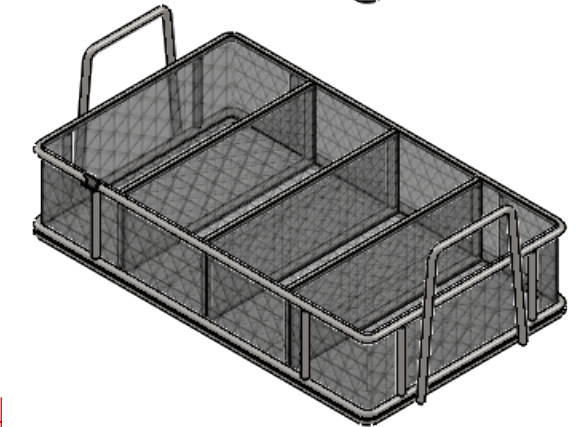
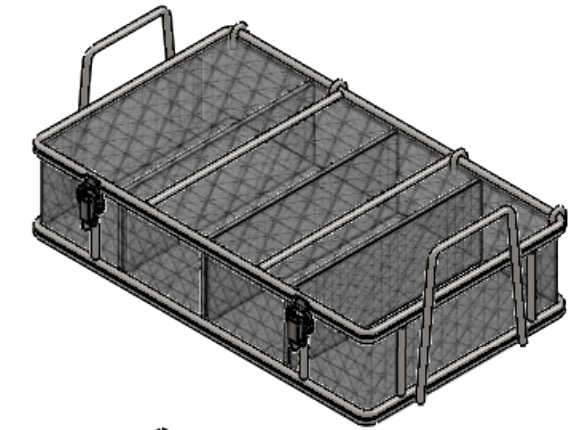
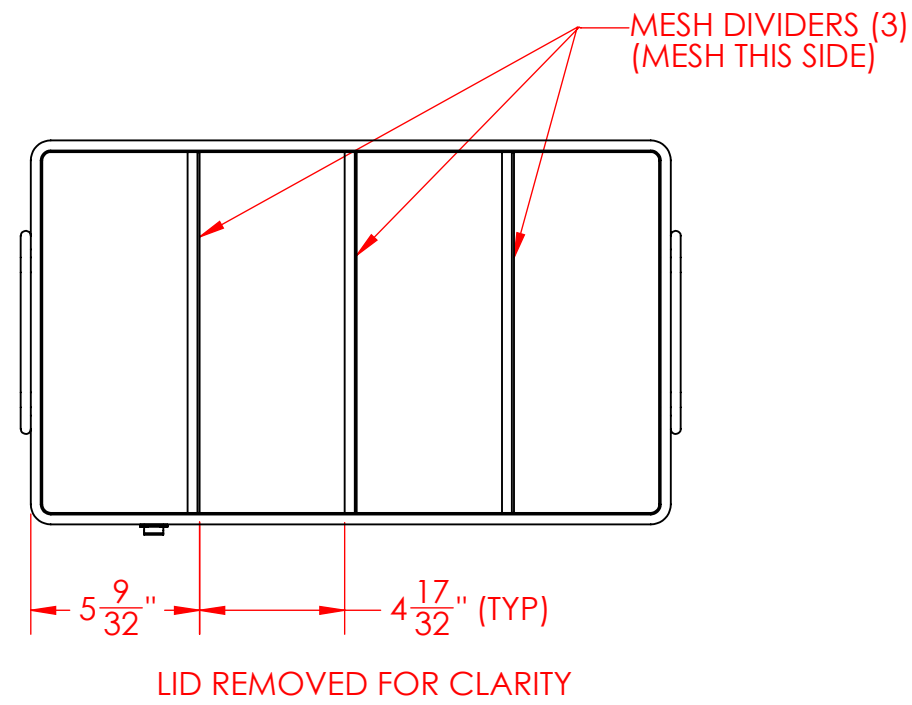
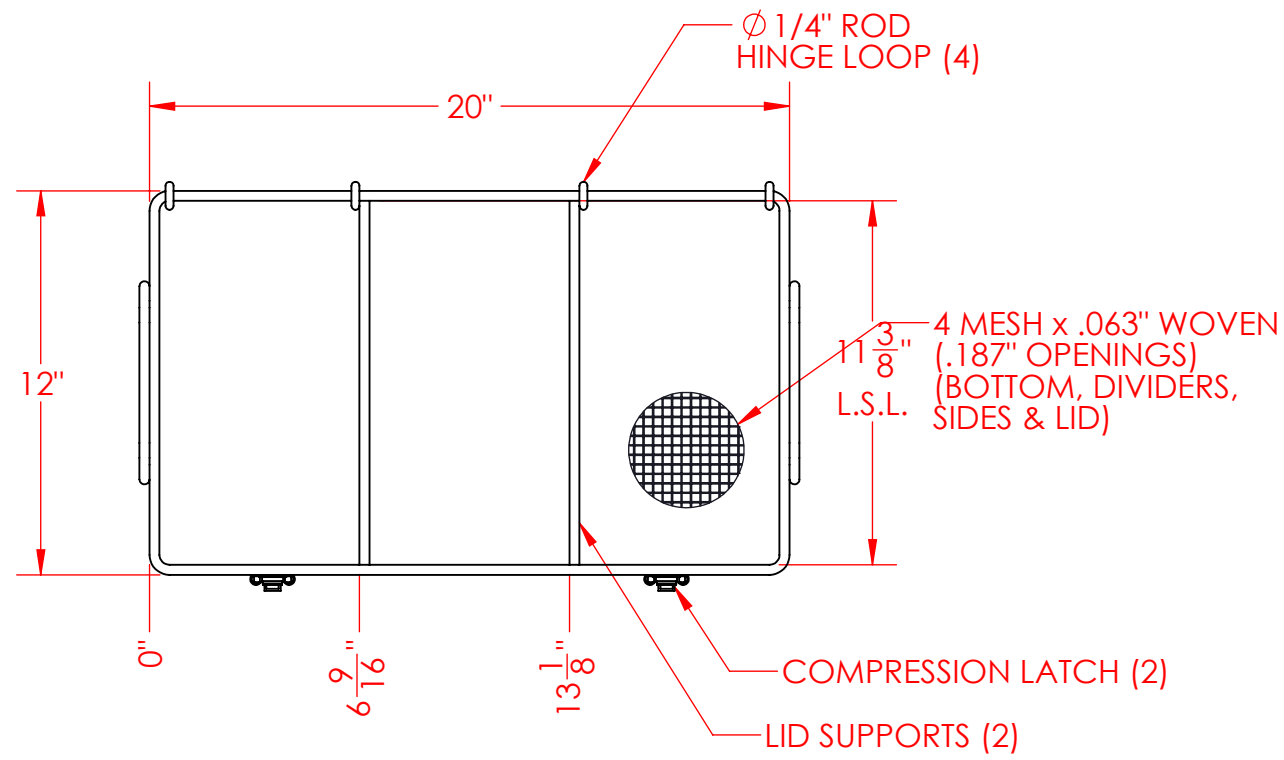

DIVIDER- (3) 4 MESH x .063" WOVEN (.187" OPENINGS) ONE SIDE OF DIVIDER

NOTE:  
 1) ALL ROD TO BE Ø 5/16" UNLESS NOTED OTHERWISE  
 2) DIVIDERS ARE WELDED IN BASKET

ESTIMATED Wt. (lbs.): 15.1

TOLERANCES UNLESS NOTED OTHERWISE  
 ANGLES: ± 2 DEGREES  
 FRACTIONS ± 1/16  
 .X ± .125  
 .XX ± .063  
 .XXX ± .032

MATERIAL: C/S  
 FINISH: Natural

THE INFORMATION CONTAINED ON THIS DOCUMENT IS CONFIDENTIAL AND IS THE INTELLECTUAL PROPERTY OF THREE M TOOL AND MAY NOT BE COPIED OR DISCLOSED WITHOUT PRIOR WRITTEN PERMISSION FROM THREE M TOOL.

REVISION SHEET SIZE

A B

PART DESCRIPTION

**Rectangular Basket with Lid**

Empire Southwest - CAT

PART NUMBER

EPR-201206

SCALE: NONE

SHEET 1 OF 1  
 CUSTOMER

**TMT** Three M Tool  
 1038 Elm Street  
 York, PA 17403  
 Phone: 717-854-6379  
 Fax: 717-845-5232  
 www.ThreeMTool.com